

INSTRUCCIONES DE MONTAJE PARA YAMAHA T-MAX 500/530/560

REF: IT605PRO / IT605XRP / IT530PRO / IT530XRP / IT5307XRP / IT560PRO / IT560XRP



PASO 1



Retira la tapa del sistema de transmisión automático

PASO 2



Retirar el variador instalado y limpiar todos los residuos de grasa, aceite y polvo.

*Conservar las arandelas del variador original.

PASO 3

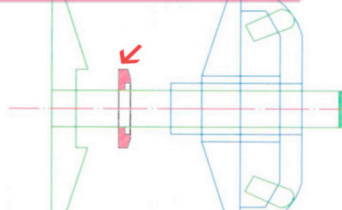

Colocar la arandela J.Costa en su posición (Ver despiece).

*Excepción: IT605PRO

PASO 4



Colocar el variador J.Costa, respetando el orden de las arandelas del variador original.

PASO 5



Bloquear polea corrector de par

PASO 6



Colocar herramienta para bloquear el variador y apretar con dinamométrica a 16kg/160Nm



VER VIDEO-TUTORIAL COMPLETO

¡INSTRUCCIONES DE MONTAJE DETALLADAS PASO A PASO!



ATENCIÓN



- El variador debe ser apretado únicamente mediante llave dinamométrica
- No añadir grasas, aceites o lubricantes para el montaje del variador J.Costa

PAR DE APRIETE

16 Kg / 160 Nm

DESPIECE DEL VARIADOR J.COSTA

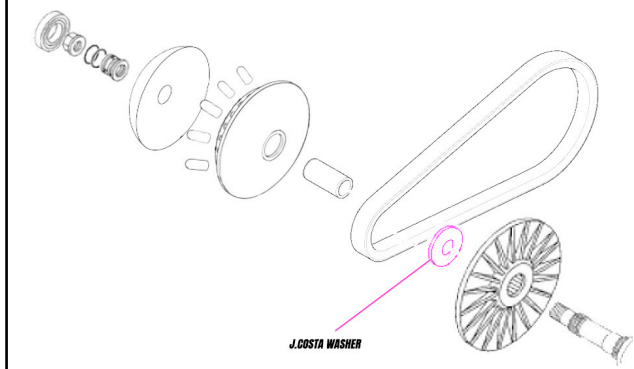

J.COSTA WASHER

RECAMBIOS

CORREA VARIADOR XRP ITXRPBL

REF: IT605PRO
CAMPANA: JC6052C
MASAS: JC16031015016MB
CASQUILLO: JC453544GI
BULÓN: JC605S

REF: IT605XRP
CAMPANA: IT530XRPC
MASAS: JC16031011516MB
CASQUILLO: JC4535375GI
BULÓN: JC60400S
ARANDELA: IT530W

REF: IT6052PRO
CAMPANA: JC6052C
MASAS: JC16034015016MB
& JC16034013516MB
CASQUILLO: JC453540GI
BULÓN: JC605S
ARANDELA: IT530W

REF: IT530XRP
CAMPANA: IT530XRPC
MASAS: JC16034012016MB
& JC1603401416MB
CASQUILLO: JC453540GI
BULÓN: JC605S
ARANDELA: IT530W

REF: IT5307XRP
CAMPANA: IT5307XRPC
MASAS: JC16034014516MB
& JC16034013516MB
CASQUILLO: JC453540GI
BULÓN: JC605S
ARANDELA: IT530W

REF: IT560XRP
CAMPANA: IT5307XRPC
MASAS: JC16034014516MB
& JC16034015516MB
CASQUILLO: JC453540GI
BULÓN: JC605S
ARANDELA: IT560W

REF: IT560PRO
CAMPANA: IT6052C
MASAS: JC16034016016MB
CASQUILLO: JC453540GI
BULÓN: JC605S
ARANDELA: IT560W

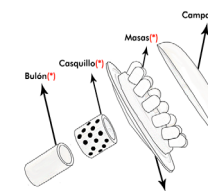

IT Conversions

ASSEMBLY INSTRUCTIONS FOR YAMAHA T-MAX 500/530/560

REF: IT605PRO / IT605XRP / IT530PRO / IT530XRP / IT5307XRP / IT560PRO / IT560XRP



STEP 1

Remove the automatic transmission cover (CVT)

STEP 2

Remove the installed variator and clean all grease or oil.

* Install all the washers on the original location

STEP 3

Set the J.Costa Washer (See the exploded view attached).

*Exception: IT605PRO

STEP 4

Install the J.Costa variator, it must be repeat the washers position as original variator

STEP 5

Block the correct par pulley

STEP 6

Fix the tool for blocking the variator and tighten with the dynamometric tool to 16kg/160Nm

WATCH THE VIDEO-TUTORIAL

DETAILED STEP-BY-STEP ASSEMBLY INSTRUCTIONS!

ATTENTION

- The variator must only be tightened with a torque wrench.
- Do not add grease, oil or lubricants for the assembly of the J.Costa variator.

TIGHTENING TORQUE

16 Kg / 160 Nm

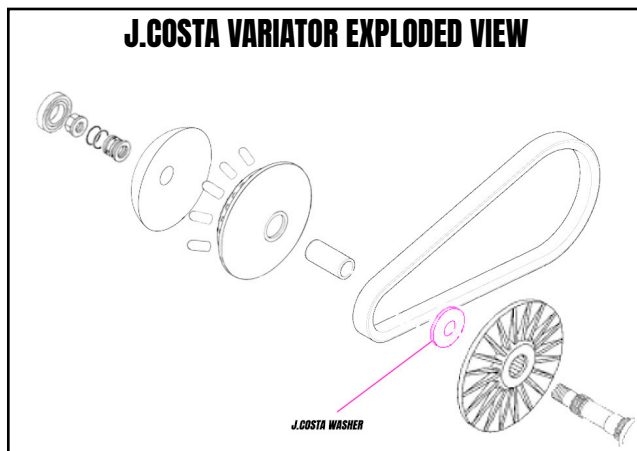

SPARE PARTS			
<p>VARIATOR XRP BELT ITXRPBL</p> <p>REF: IT605PRO BELL: JC6052C ROLLER: JC16031015016MB BUSHING: JC453544GI SLIDER: JC605S</p> <p>REF: IT605XRP BELL: IT530XRPC ROLLER: JC16031011516MB BUSHING: JC4535375GI SLIDER: JC60400S WASHER: IT530W</p>	<p>REF: IT6052PRO BELL: JC6052C ROLLER: JC16034013516MB & JC16034013516MB BUSHING: JC453540GI SLIDER: JC605S WASHER: IT530W</p> <p>REF: IT530XRP BELL: IT530XRPC ROLLER: JC16034012016MB & JC1603401416MB BUSHING: JC453540GI SLIDER: JC605S WASHER: IT530W</p>	<p>REF: IT5307XRP BELL: IT5307XRPC ROLLER: JC16034014516MB & JC16034013516MB BUSHING: JC453540GI SLIDR: JC605S WASHER: IT530W</p> <p>REF: IT560XRP BELL: IT5307XRPC ROLLER: JC16034014516MB & JC16034015516MB BUSHING: JC453540GI SLIDER: JC605S WASHER: IT560W</p>	<p>REF: IT560PRO BELL: IT6052C ROLLER: JC16034016016MB BUSHING: JC453540GI SLIDER: JC605S WASHER: IT560W</p> <p>(* Consultar)</p>